

PRODUCT INFORMATION

END FITTINGS

SK-System

Fluent combinations ...

A team as one. Combines anything with everything: ropes, chains, lashings. Including insulated swivels. The ideal system to connect crane and load.

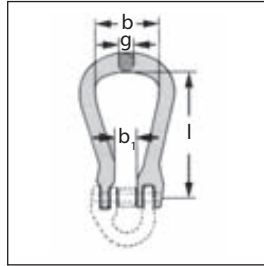

Master link (open) SKO type

Nominal Size = Nominal chain dia.	Working Load Limit (WLL)	Weight ~ kg/ea	Measurements			
			b	b ₁	g	l
mm	t		mm	mm	mm	mm
7/8	2	0,3	50	15	14	99
10	3,15	0,6	66	20	18	127
13	5,3	1,0	72	25	22	145
16	8	1,6	82	30	25	175
18/20	12,5	2,6	105	36	30	204

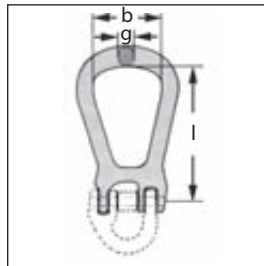

Master link (closed) SKG type

Nominal Size = Nominal chain dia.	Working Load Limit (WLL)	Weight ~ kg/ea	Measurements		
			b	g	l
mm	t		mm	mm	mm
7/8	2	0,3	50	14	99
10	3,15	0,6	66	18	127
13	5,3	1,1	72	22	145
16	8	1,7	82	25	175
18/20	12,5	2,8	105	30	204

Half link SKT type

incl. SKA

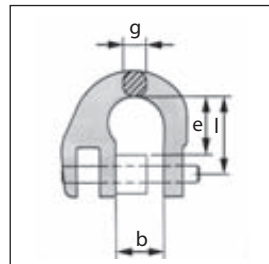

Nominal Size = Nominal chain dia.	Working Load Limit (WLL)	Weight ~ kg/ea	Measurements			
			b	e	g	l
mm	t		mm	mm	mm	mm
7/8	2	0,1	18	22	9	28
10	3,15	0,2	25	26	12	34
13	5,3	0,4	29	33	15	44
16	8	0,7	36	40	19	52
19	12,5	1,1	43	48	22	63
22	15	1,7	49	59	24	75
26	21,2	2,6	58	61	29	80

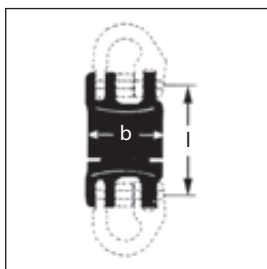

Roller bearing swivel SKLI type

Nominal Size = Nominal chain dia.	Working Load Limit (WLL)	Weight	Measurements	
			d	l
mm	t	~ kg/ea	mm	mm
7/8	2	0,7	48	75
10	3,15	1,4	59	96
13	5,3	2,9	75	120
16	8	4,9	90	137
18/20	12,5	7,2	104	159

Current leakage max. 1000 V when welding loads suspended from electric crane. Perfect rotation even under maximum load.

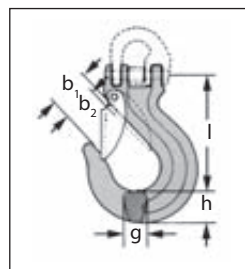

Safety hoist hook ESKN type with latch

Nominal Size = Nominal chain dia.	Working Load Limit (WLL)	Weight	Measurements				
			b ₁	b ₂	g	h	l
mm	t	~ kg/ea	mm	mm	mm	mm	mm
7/8	2	0,4	32	27	18	21	90
10	3,15	0,9	40	34	23	29	115
13	5,3	1,8	48	42	28	36	141
16	8	3,4	54	62	34	43	181
18/20	12,5	5,0	59	67	41	51	197

Shank coupling SKS type

Standard configuration with unmachined shaft

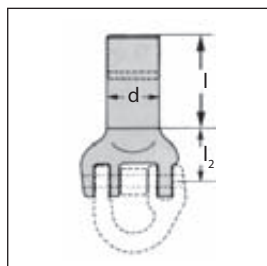

Nominal Size = Nominal chain dia.	Working Load Limit (WLL)	Weight	Measurements			
			d	d _{min}	l	l ₂
mm	t	~ kg/ea	mm	mm	mm	mm
7/8	2	0,5	30	13	70	27
10	3,15	0,9	36	16	85	34
13	5,3	1,4	42	20	100	43
16	8	2,5	50	25	112	52
18/20	12,5	4,7	70	30	88	55

When machining the shaft the diameter must not fall below the indicated d_{min} under consideration of the permitted working load limit. The thread length must be no less than 1,5·d_{min}.

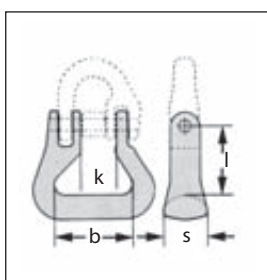

Round sling coupling SKR type

Nominal Size = Nominal chain dia.	Working Load Limit (WLL)	Weight	Measurements			
			b	k	l	s
mm	t	~ kg/ea	mm	mm	mm	mm
7/8	2	0,2	40	18	35	24
10	3,15	0,4	47	24	42	29
13	5,3	0,7	53	29	50	35
16	8	1,2	67	35	62	43
18/20	12,5	1,9	80	43	71	52
22	15	5,0	125	50	110	70
26	21,2	8,5	150	58	130	86

